



## Side-by-Side Milking parlour Global 90i

First class in comfort and performance

GEA Milking & Cooling | WestfaliaSurge

engineering for a better world

GEA Farm Technologies



0348

0348

0369

# Comfortable milking for cows and people with the Global 90i

... first class milking

## Global 90i means:

A comfortable, smooth milking experience for the cows and operators. With its compact design, the Global 90i does not take up a lot of room, and only necessitates the operator to cover short distances regardless of the size of the parlour. But it also offers a fantastic amount of space for every breed of cow. The modern, curved, hot galvanised frame can withstand any load without bending.

## Open door

The wide entrance invites your cows into the milking parlour: The cows move into place quickly, comfortably and without any stress; once in position the cow is in its own stall, undisturbed by others. When the last animal is in its stall the entrance gate closes flush with the last milking place, and the whole group is well-positioned.

## First class comfort: individual indexing

Your cows immediately get into the best position for milking with the help of the individual indexing system. The weight of the individual exit gate presses on the animal's shoulders, easing it safely and comfortably back towards the operator. It is then in the correct place and accessible to the operator for milking.

## Clean

*The sturdy, stainless steel dung channel protects the operator from getting dirty, and keeps the work area exceptionally clean.*





#### **Your free space.**

Together with the individual indexes the animal-friendly design gives your cows the amount of space and room for movement it requires. **The effect: less stress for man and animal.** The quick exit rounds off the package and makes Global 90i into one of the "quickest" milking parlours with high throughput.

#### **Individual exit of animals!**

In addition to the quick exit in the Global 90i, it is also possible to select each individual animal. Each front segment can be opened independently to release the individual animal from the milking parlour in the shortest time (option). **This saves valuable time, cost and trouble.**





*Counterbalance secures the path of the hose. Depending on the individual milking parlour equipment, you can start the milking process quite conveniently with your leg or just by slightly lifting the milking equipment. No matter the equipment on which you decide, you have both hands free for quicker positioning.*

### **Design with MultiLine**

In connection with MultiLine, you can recognise Global 90i immediately by the unmistakable operation front. In this clear, easy-to-maintain work environment, milking is fun. The milking technology integrated in MultiLine is protected against dust and dampness. For the few, important servicing tasks, the MultiLine cladding can be easily opened with two movements of the hand. MultiLine helps to keep down the noise level in the milking parlour for human being and animal.

### **First-class flexibility**

Global 90i comes starting from the size range 2 x 8 to 2 x 50 also in one-sided design – for any size of herd. If your herds grow, then you just extend your milking parlour conveniently by individual modules. Global 90i increases the throughput continuously! Whether for medium-sized or big herds. Long life, higher profitability and effective work distinguish this milking parlour with its high stability and security for human and animal.



*With the EGO 100 lifting floor, ergonomic body posture means noticeable relief for your body. (Option)*



**Model:**  
**Global 90i without subway**



**Model: Global 90i Subway**

In this model, the service-relevant milking technology components are mounted below the milking pit (central subway) or below the standing area for the animals (dual subway). The subway system offers a guarantee for a clean and dry, easily accessible work environment and enables servicing work even during milking operation. The lifetime of all important components is extended by this.

## IllumiCurb

### Parlour lighting where you need it

Early detection of injuries and changes in the udder condition and teats is becoming ever more important – in particular from an economic point of view.

The robust LED strip, IllumiCurb, gives full coverage to the udder and simplifies your milking routine. Changes in the udder condition can be detected more easily and treated in good time. A good visualisation of the udder is an important step towards achieving improved udder health and increased milk production.

*IllumiCurb ensures adequate lighting of the udder (optional retrofit).*



## DairyDesignService:

### On-site consultancy for you is particularly important to us.

You can profit thereby from the experience of our worldwide network of excellent “dairy design experts”. Our consultancy does not finish on completion of the system. We shall instruct your staff expertly and guarantee full utilisation of your system through continual training.

### We will support you from the very beginning.

Standard and installation plans will help you in the planning and construction. In addition, we can draw up individual solutions for you on the CAD system. You can see immediately what your desired system looks like no matter of which size, planned consistently in accordance with your individual demands.

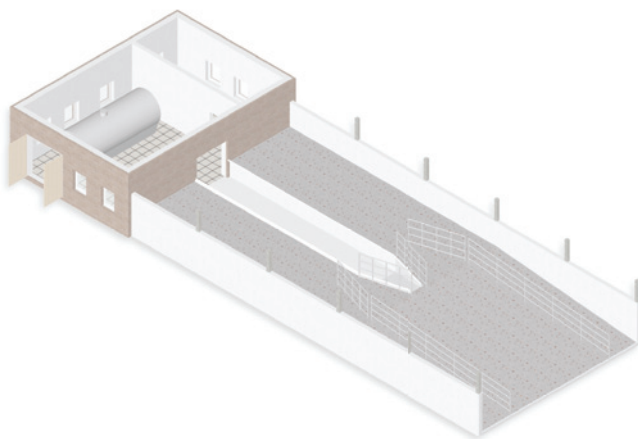

### Your benefits at a glance

- Convenient milking for human being and animal
- Frictionless and stress-free milking process with short work ways
- Sufficient space for any race of cow
- Easy milking parlour access (operability)
- Optimum, individual position of the animals
- High level of stability through robust construction for the security of human being and animal
- Quick exit for high throughput performance
- Little servicing through high-quality components



*We live our values.*

Excellence • Passion • Integrity • Responsibility • GEA-versity

GEA Group is a global engineering company with multi-billion euro sales and operations in more than 50 countries. Founded in 1881, the company is one of the largest providers of innovative equipment and process technology. GEA Group is listed in the STOXX® Europe 600 index.

**GEA Farm Technologies GmbH**

Siemensstraße 25 - 27, D-59199 Bönen  
Phone +49 (0) 23 83 93 7-0, Fax +49 (0) 23 83 93 8-0  
[www.gea.com](http://www.gea.com) | [www.gea-farmtechnologies.com](http://www.gea-farmtechnologies.com)